



Demo Kit



Bulletin No. KA230222



Certificate No.: FM 72815

Kaustubha Udyog

AN ISO9001:2015 COMPANY

S. No. 36/1/1, Sinhgad Road, Vadgaon Khurd, Near Lokmat Press, Pune 411 068 INDIA

Tel. : +91-(0) 20-24393577 / 24393877

Telefax : +91-(0) 20-24393577 / 25460486

Email : support@ogauge.in

Website : www.ogauge.io

Ogauge Demo Kit

Ogauge demo kit has been designed so that it would be easy to demonstrate the capabilities of Ogauge and also be able to simulate the actual working of Ogauge in a process system.

Contents of the Kit

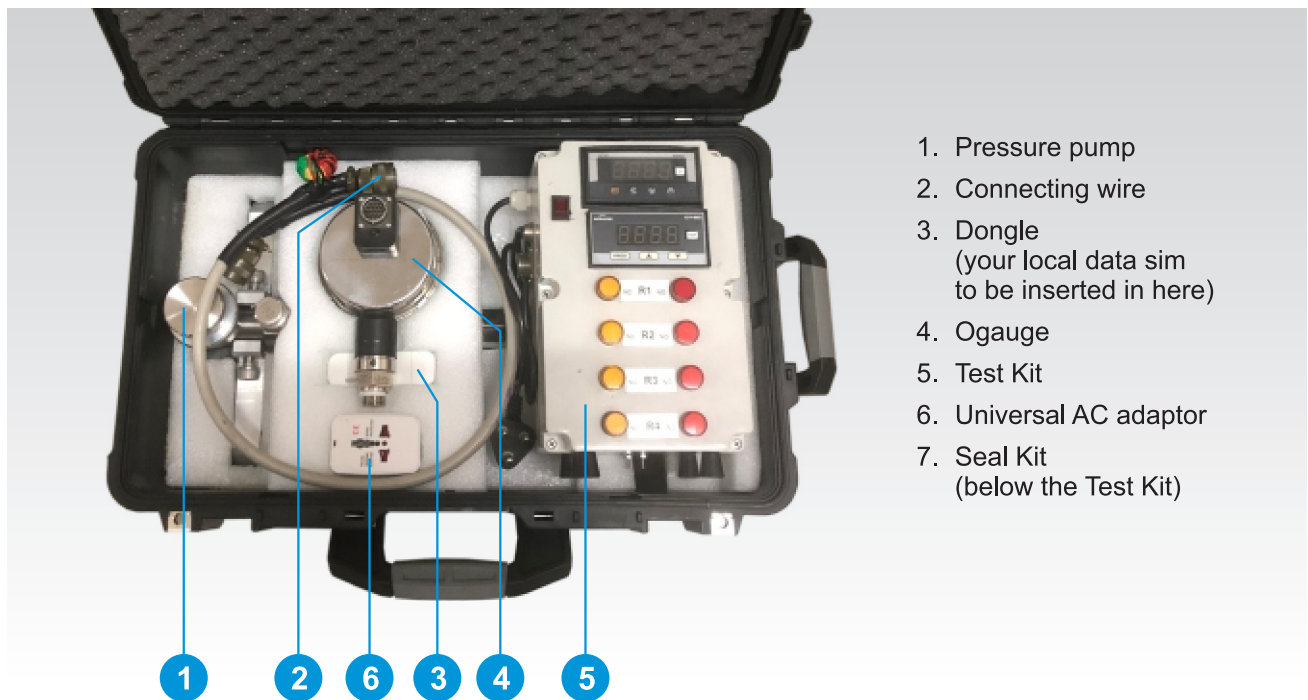

1

Pressure Pump

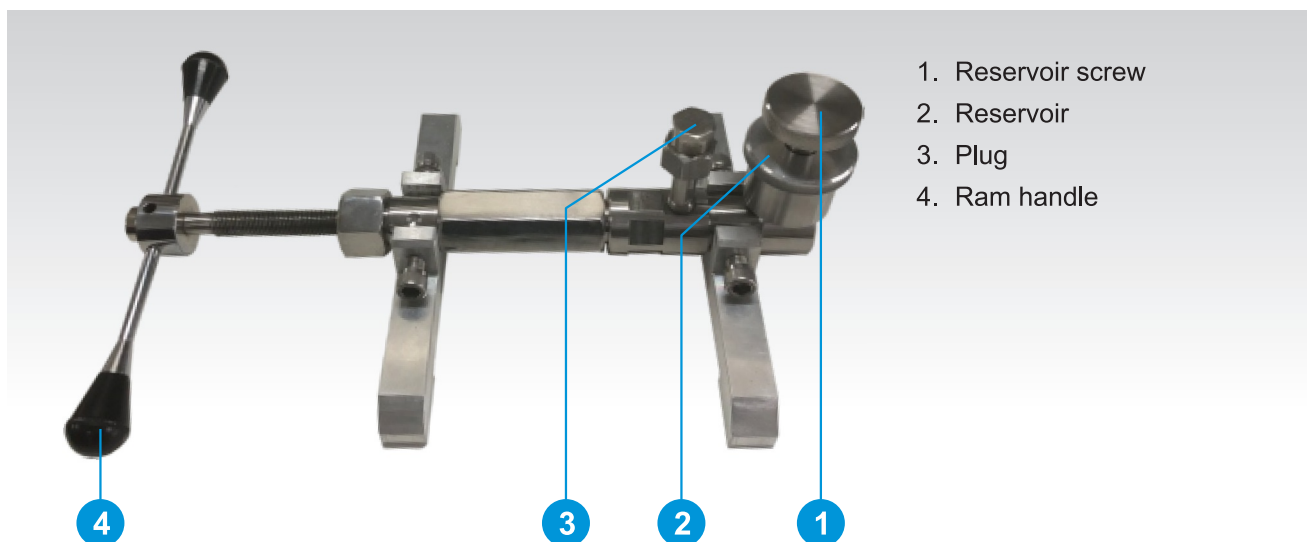

2

Connecting Wire

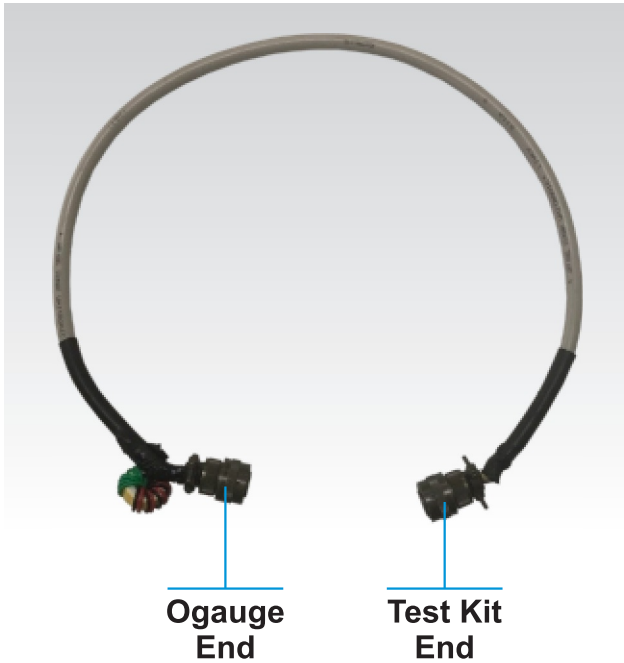

The connecting wire connects the Ogauge with the Test kit. It is presoldered as per the wiring terminations. The end with the choke should be wired to the Ogauge.

3

Dongle

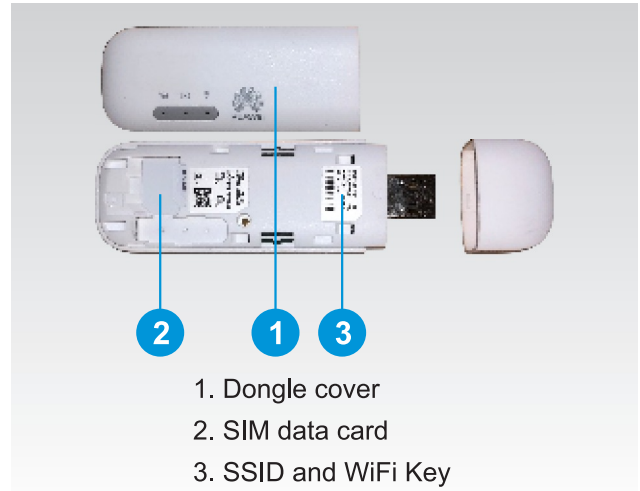

Remove the WiFi dongle cover and insert an activated data card. The Ogauge has been fed with the SSID and WiFi key of this dongle. Please use this dongle with your laptop, when demonstrating the dashboard to the client.

Please ensure the dongle is in proper range and has a full signal, and is close to the Ogauge.

When the signal LED on the dongle glows in full magenta, and the rest two are green, it means the dongle is receiving proper signal.

4

Ogauge



5

Test Unit

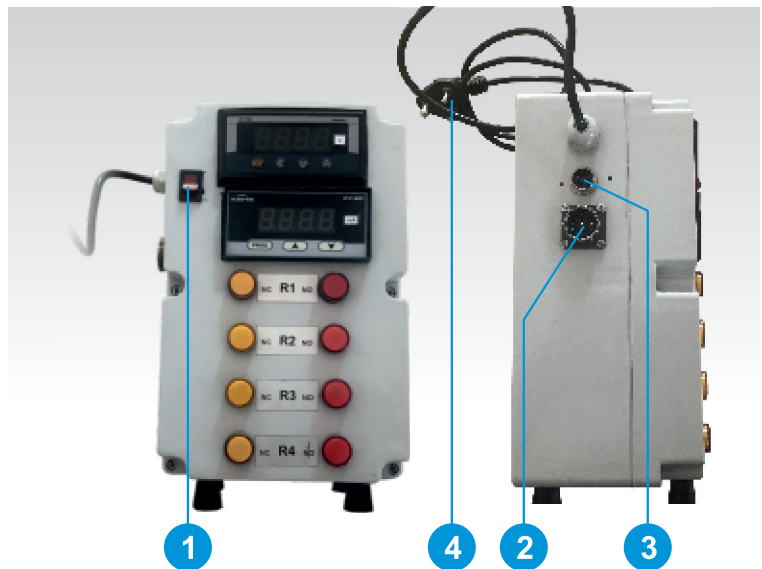

1. On – off button

2. 19 pin connector

3. Additional port for 24VDC output

4. AC plug, to be lugged in to AC outlet 230 VAC or 110 VAC

6

Universal AC Adaptor

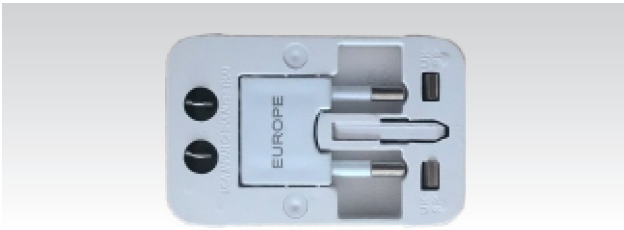

The universal adaptor is supplied to suit the AC connections around most countries of the world.

7

Seal Kit

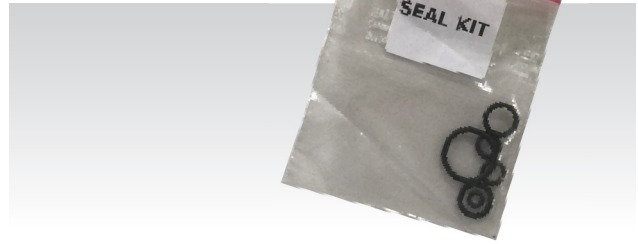

Before setting up the test kit and the demonstration of the Ogaugé, it would be advisable that one downloads the mobile app on one's android or iphone. The apps are available on the Google Playstore and also on the Apple store.

You can use the dongle wifi SSID and key to pair the laptop to demonstrate the dashboard capabilities.

Setting Up

It is easy to set up the demo kit.

- Pressure pump is so designed that one can easily pressurise the Ogaugé upto 400 bar. It operates on water.
- Remove all components from the bag onto a table. Place the pressure pump at a stable place.
- Mount the Ogaugé after removing the seal plug on the pressure pump.
- Connect the wire to the test kit and the other end to the Ogaugé.
- Connect the dongle to the laptop, after turning the laptop on.
- Plug the test kit to an AC outlet having 230 VAC or 110 VAC current. Turn on the Test kit by switching on the red on / off button.
- Fill the reservoir with water.
- To fill the system with water proceed as follows:
 - 1a. Unscrew the inlet screw of reservoir
 - 1b. Take the ram out by rotating the ram handle anticlockwise to the extreme end. This will fill the system with water.
 - 1c. To remove any air trapped inside the system, turn the ram handle clockwise to the extreme end. The presence of air is established if bubbles appear in the reservoir.
- Repeat steps 1b and 1c till no bubbles appear in the reservoir.
- Take the ram handle fully out and tighten the inlet screw. When the ram handle is rotated clockwise, the pressure in the system starts increasing. Turning the handle anticlockwise reduces the pressure.
- It may be necessary to demonstrate the dashboard settings on a laptop. The laptop can be paired to the dongle. The SSID and password of the individual dongle can be known by removing the cover of the dongle. It is usually written on a sticker pasted where the data SIM is inserted.

